



OFFICE OF THE CITY CLERK  
CITY OF CHICAGO  
ANNA VALENCIA

OFFICE OF THE  
CITY CLERK

17 FEB 22 PM 3:50

RECEIVED

NOTICE OF INTENT FORM

1. Submit a complete and accurate description of the precinct you wish to restrict.

The description of the precinct boundaries of the 2 Precinct of the 13 Ward of the City of Chicago in the County of Cook and the State of Illinois, as such precinct existed as of the last General Election, is as follows:

please see the attached

2. Please select the scope of restriction sought for the 2 Precinct of the 13 Ward:

A: Restricting Shared Housing Units and Vacation Rentals

- Restrict all new or additional *shared housing units AND vacation rentals*.
- Restrict all new or additional *shared housing units*.
- Restrict all new or additional *vacation rentals*.

OR

B: Restricting Shared Housing Units and Vacation Rentals that are NOT their owner's Primary Residence:

- Restrict all new or additional *shared housing units AND vacation rentals* that ARE NOT their owner's or tenant's primary residence.
- Restrict all new or additional *shared housing units* that ARE NOT their owner's or tenant's primary residence
- Restrict all new or additional *vacation rentals* that ARE NOT their owner's or tenant's primary residence.

Paul M Rybski  
Petitioner Name

Paul M Rybski  
Signature

2-21-17  
Date

## **PCT 02 WARD 13**

Beginning at the intersection of S. Merrimac Av. (extended) and the Indiana Harbor Belt R.R., thence east on the Indiana Harbor Belt R.R. to S. Austin Av., thence south on S. Austin Av. to W. 61<sup>st</sup> St., thence west on W. 61<sup>st</sup> St. to S. Merrimac Av. and thence north on S. Merrimac Av. to the place of beginning.

# PCT 02 WARD 13

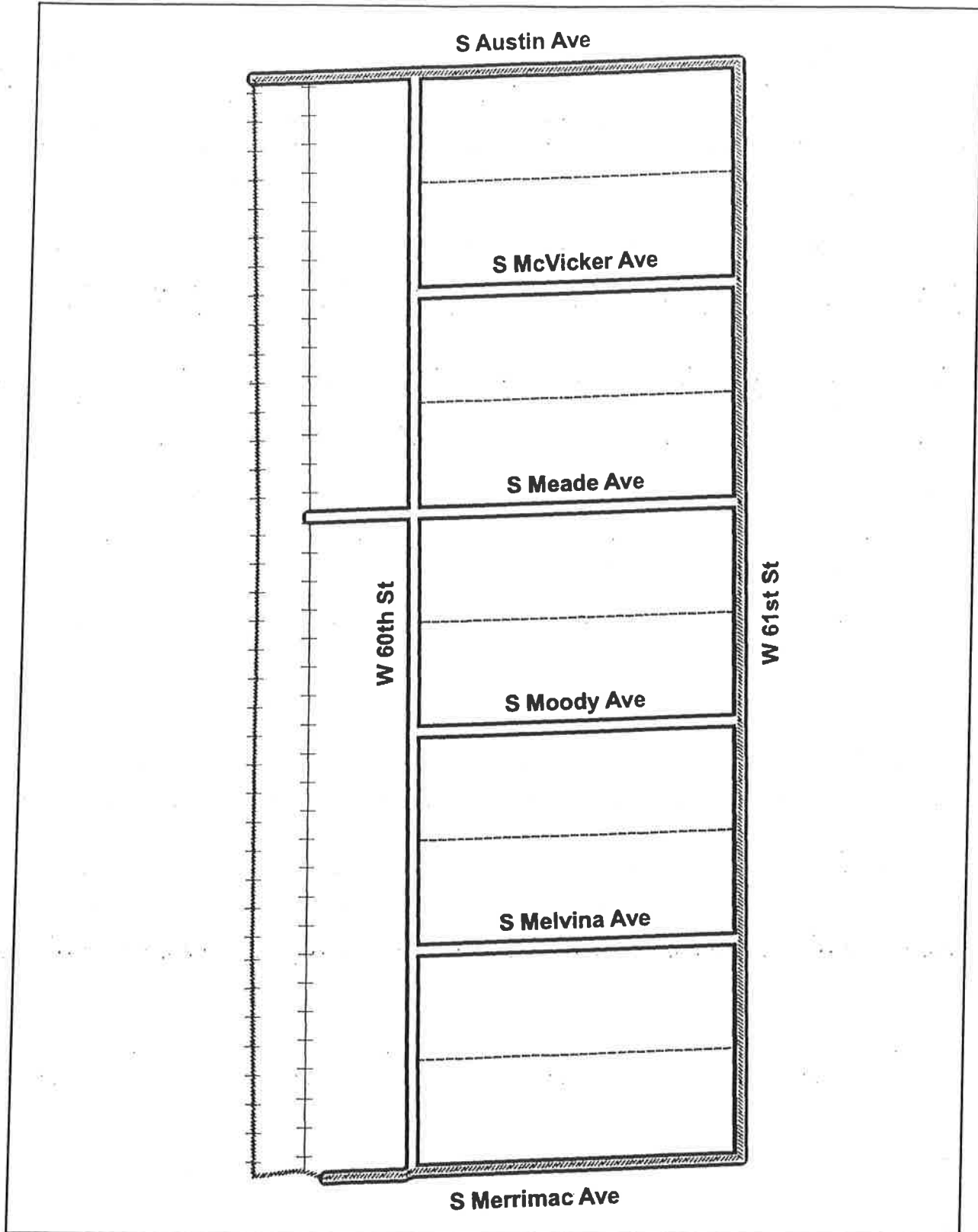

## Legend

- Precinct Boundary
- Freeway
- Major Street
- Local Street
- Service Drive
- Ramp
- Alley
- Streams
- Railroad

Board of Elections  
City of Chicago  
69 W Washington, Suite 600  
Chicago, IL 60602  
312-269-7900  
[www.chicagoelections.com](http://www.chicagoelections.com)

September 19, 2012

