



OFFICE OF THE CITY CLERK
CITY OF CHICAGO
ANNA VALENCIA

OFFICE OF THE
CITY CLERK

17 MAR -3 AM 10:39

RECEIVE

NOTICE OF INTENT FORM

1. Submit a complete and accurate description of the precinct you wish to restrict.

The description of the precinct boundaries of the 26 Precinct of the 13 Ward of the City of Chicago in the County of Cook and the State of Illinois, as such precinct existed as of the last General Election, is as follows:

please see the attached.

2. Please select the scope of restriction sought for the 26 Precinct of the 13 Ward:

A: Restricting Shared Housing Units and Vacation Rentals

- Restrict all new or additional *shared housing units AND vacation rentals*.
- Restrict all new or additional *shared housing units*.
- Restrict all new or additional *vacation rentals*.

OR

B: Restricting Shared Housing Units and Vacation Rentals that are NOT their owner's Primary Residence:

- Restrict all new or additional *shared housing units AND vacation rentals* that ARE NOT their owner's or tenant's primary residence.
- Restrict all new or additional *shared housing units* that ARE NOT their owner's or tenant's primary residence
- Restrict all new or additional *vacation rentals* that ARE NOT their owner's or tenant's primary residence.

ELIZABETH CONDI-WEISS

Petitioner Name

Elizabeth Condi-Weiss

Signature

March 2, 2017

Date







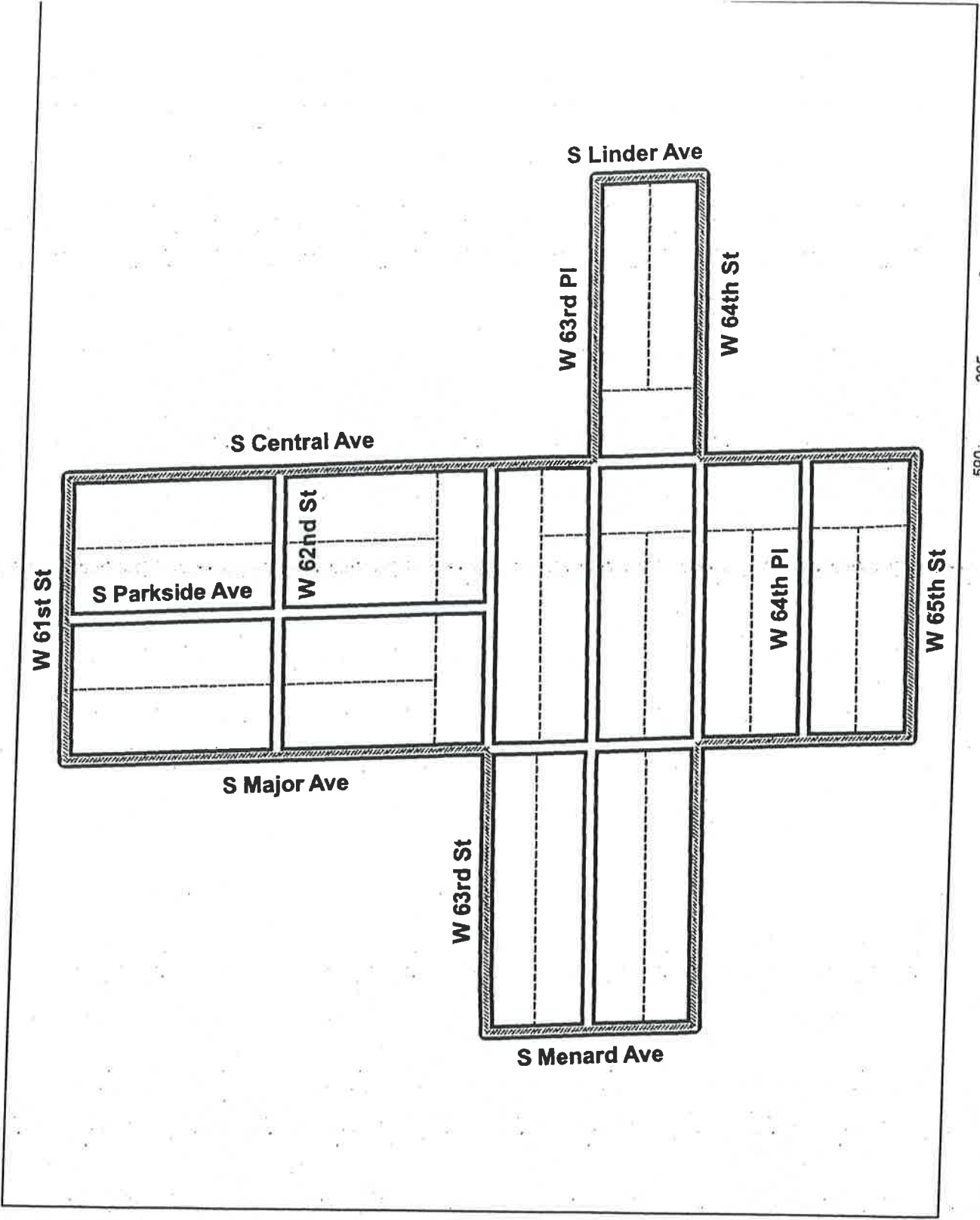

PCT 26 WARD 13

Beginning at the intersection of S. Major Av. and W. 61st St., thence east on W. 61st St. to S. Central Av., thence south on S. Central Av. to W. 63rd Pl., thence east on W. 63rd Pl. to S. Linder Av., thence south on S. Linder Av. to W. 64th St., thence west on W. 64th St. to S. Central Av., thence south on S. Central Av. to W. 65th St., thence west on W. 65th St. to S. Major Av., thence north on S. Major Av. to W. 64th St., thence west on W. 64th St. to S. Menard Av., thence north on S. Menard Av. to W. 63rd St., thence east on W. 63rd St. to S. Major Av. and thence north on S. Major Av. to the place of beginning.

PCT 26 WARD 13



Legend

-  Precinct Boundary
-  Freeway
-  Major Street
-  Local Street
-  Service Drive
-  Ramp
-  Alley
-  Streams
-  Railroad

Board of Elections
 City of Chicago
 69 W Washington, Suite 600
 Chicago, IL 60602
 312-269-7900
www.chicagoelections.com

September 19, 2012

