

RECEIVED
#3
2017 APR 11 PM 12:01
OFFICE OF THE
CITY CLERK



OFFICE OF THE CITY CLERK
CITY OF CHICAGO
ANNA VALENCIA

RECEIVED
17 APR 10 PM 10:31
OFFICE OF THE
CITY CLERK

NOTICE OF INTENT FORM

1. Submit a complete and accurate description of the precinct you wish to restrict.

The description of the precinct boundaries of the 2 Precinct of the 23 Ward of the City of Chicago in the County of Cook and the State of Illinois, as such precinct existed as of the last General Election, is as follows:

please see attached

2. Please select the scope of restriction sought for the 2 Precinct of the 23 Ward:

A: Restricting Shared Housing Units and Vacation Rentals

- Restrict all new or additional *shared housing units AND vacation rentals*.
- Restrict all new or additional *shared housing units*.
- Restrict all new or additional *vacation rentals*.

OR

B: Restricting Shared Housing Units and Vacation Rentals that are NOT their owner's Primary Residence:

- Restrict all new or additional *shared housing units AND vacation rentals* that **ARE NOT** their owner's or tenant's primary residence.
- Restrict all new or additional *shared housing units* that **ARE NOT** their owner's or tenant's primary residence
- Restrict all new or additional *vacation rentals* that **ARE NOT** their owner's or tenant's primary residence.

JOSEPH KOZMIN
Petitioner Name

Joseph Kozmin
Signature

4/11/17
Date







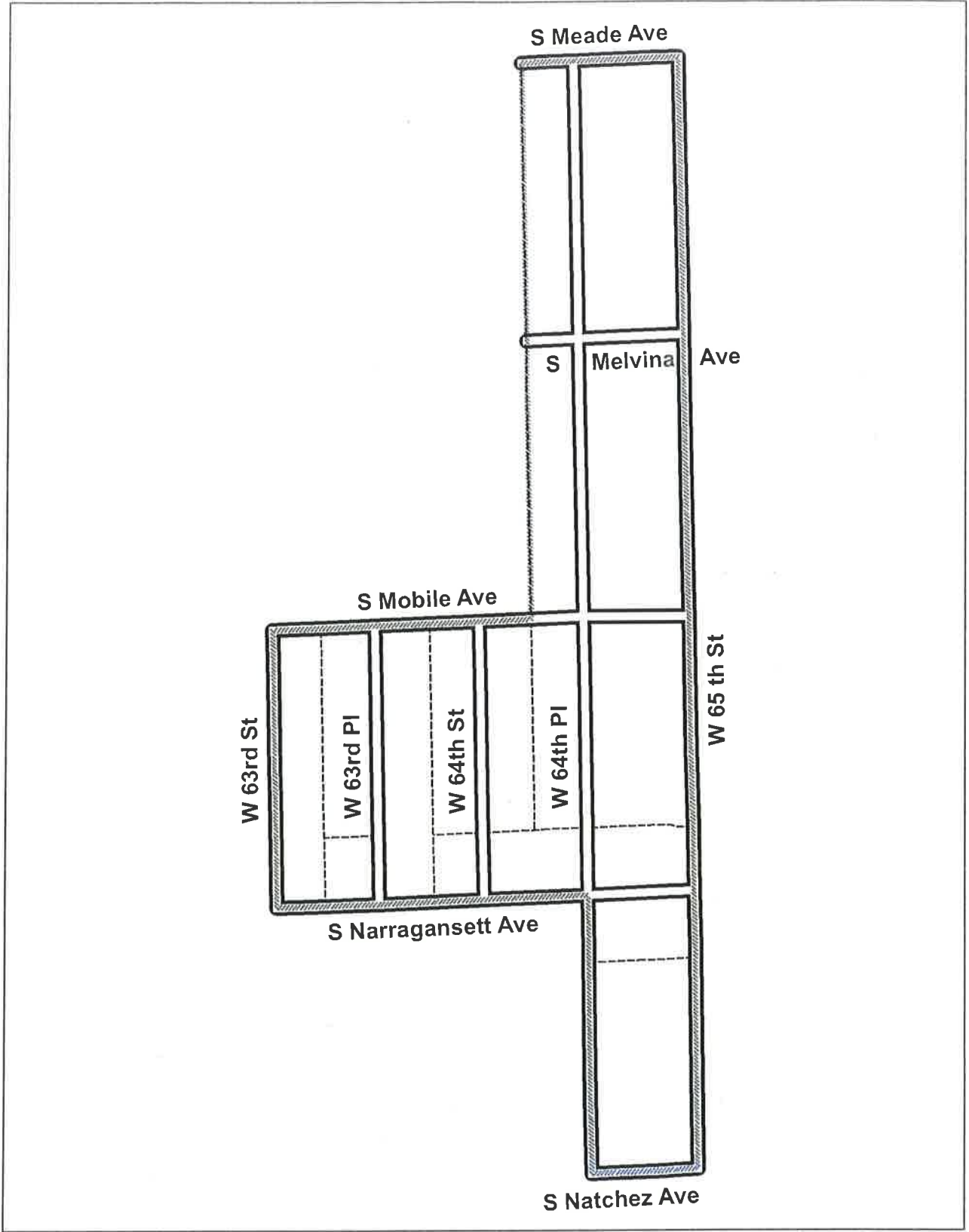

PCT 02 WARD 23

Beginning at the intersection of S. Narragansett Av. and W. 63rd St., thence east on W. 63rd St. to S. Mobile Av., thence south on S. Mobile Av. to the alley north of W. 64th Pl., thence east on the alley north of W. 64th Pl. to S. Meade Av., thence south on S. Meade Av. to W. 65th St., thence west on W. 65th St. to S. Natchez Av., thence north on S. Natchez Av. to W. 64th Pl., thence east on W. 64th Pl. to S. Narragansett Av., and north on S. Narragansett Av. to the place of beginning.

PCT 02 WARD 23



Legend

-  Precinct Boundary
-  Freeway
-  Major Street
-  Local Street
-  Service Drive
-  Ramp
-  Alley
-  Streams
-  Railroad

Board of Elections
 City of Chicago
 69 W Washington, Suite 600
 Chicago, IL 60602
 312-269-7900
www.chicagoelections.com

