

RECEIVED  
#3



2017 APR 11 AM 11:14

OFFICE OF THE  
CITY CLERK

OFFICE OF THE CITY CLERK  
CITY OF CHICAGO  
ANNA VALENCIA

ML  
17 APR 10 PM 11:09  
OFFICE OF THE  
CITY CLERK  
RECEIVED

NOTICE OF INTENT FORM

1. Submit a complete and accurate description of the precinct you wish to restrict.

The description of the precinct boundaries of the 23 Precinct of the 23 Ward of the City of Chicago in the County of Cook and the State of Illinois, as such precinct existed as of the last General Election, is as follows:

Please see attached.

2. Please select the scope of restriction sought for the 23 Precinct of the 23 Ward:

A: Restricting Shared Housing Units and Vacation Rentals

- Restrict all new or additional *shared housing units AND vacation rentals*.
- Restrict all new or additional *shared housing units*.
- Restrict all new or additional *vacation rentals*.

OR

B: Restricting Shared Housing Units and Vacation Rentals that are NOT their owner's Primary Residence:

- Restrict all new or additional *shared housing units AND vacation rentals* that ARE NOT their owner's or tenant's primary residence.
- Restrict all new or additional *shared housing units* that ARE NOT their owner's or tenant's primary residence
- Restrict all new or additional *vacation rentals* that ARE NOT their owner's or tenant's primary residence.

Matthew Skora  
Petitioner Name

Matthew Skora  
Signature

04/11/17  
Date







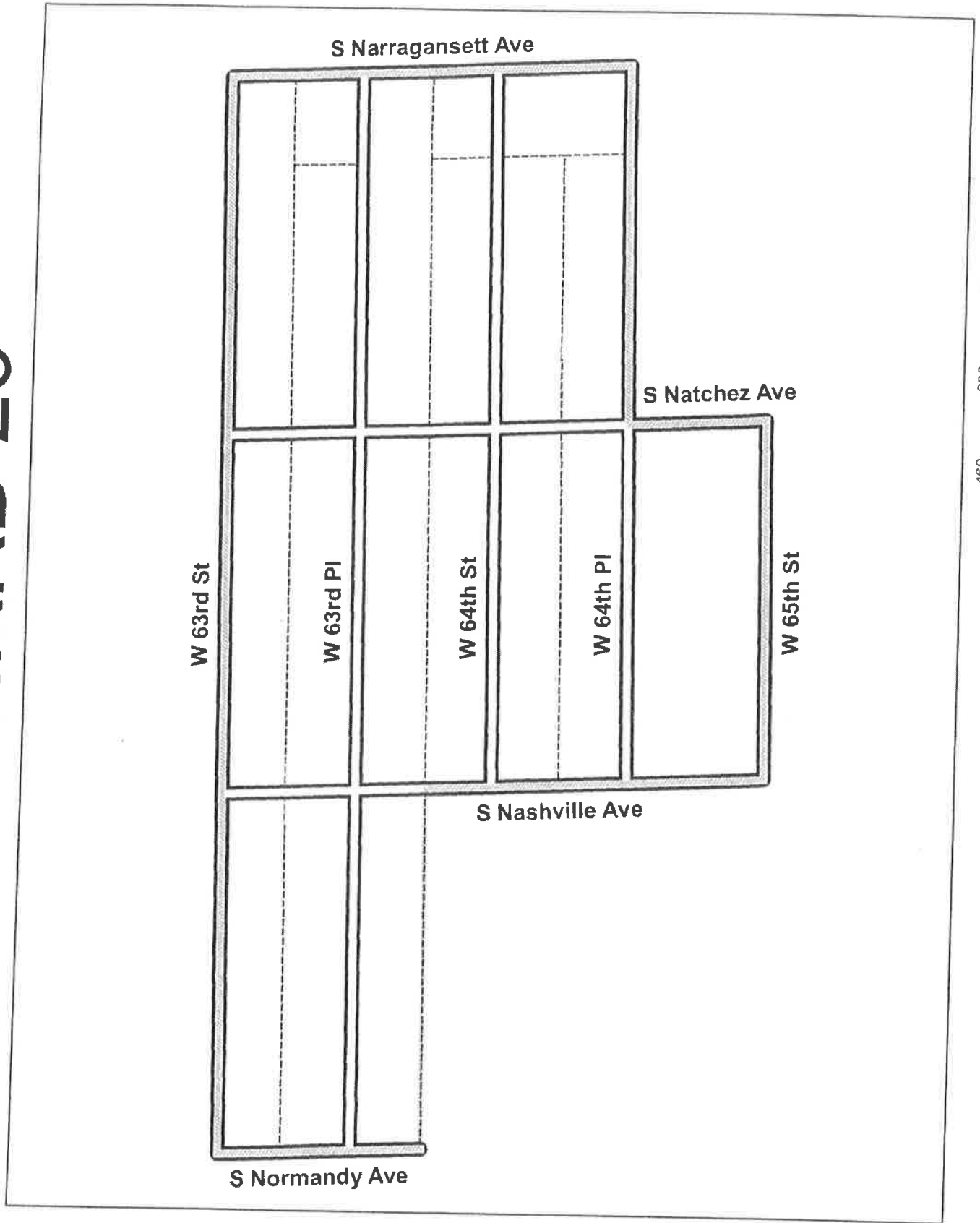

## PCT 23    WARD 23

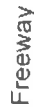
Beginning at the intersection of S. Normandy Av. and W. 63<sup>rd</sup> St., thence east on W. 63<sup>rd</sup> St. to S. Narragansett Av., thence south on S. Narragansett Av. to W. 64<sup>th</sup> Pl., thence west on W. 64<sup>th</sup> Pl. to S. Natchez Av., thence south on S. Natchez Av. to W. 65<sup>th</sup> St., thence west on W. 65<sup>th</sup> St. to S. Nashville Av., thence north on S. Nashville Av. to the alley south of W. 63<sup>rd</sup> Pl., thence west on the alley south of W. 63<sup>rd</sup> Pl. to S. Normandy Av., and north on S. Normandy Av. to the place of beginning.

# PCT 23 WARD 23



## Legend

-  Precinct Boundary
-  Freeway
-  Major Street
-  Local Street
-  Service Drive
-  Ramp
-  Alley
-  Streams
-  Railroad

Board of Elections  
City of Chicago  
69 W Washington, Suite 600  
Chicago, IL 60602  
312-269-7900  
[www.chicagoelections.com](http://www.chicagoelections.com)

September 19, 2012

