



OFFICE OF THE CITY CLERK
CITY OF CHICAGO
ANNA VALENCIA

RECEIVED #5
2018 JAN 22 PM 3:15
RECEIVED BY CITY CLERK'S OFFICE

NOTICE OF INTENT FORM

1. Submit a complete and accurate description of the precinct you wish to restrict.

The description of the precinct boundaries of the 9 Precinct of the 13 Ward of the City of Chicago in the County of Cook and the State of Illinois, as such precinct existed as of the last General Election, is as follows:

please see the attached.

2. Please select the scope of restriction sought for the ___ Precinct of the ___ Ward:

A: Restricting Shared Housing Units and Vacation Rentals

- Restrict all new or additional *shared housing units AND vacation rentals*.
- Restrict all new or additional *shared housing units*.
- Restrict all new or additional *vacation rentals*.

OR

B: Restricting Shared Housing Units and Vacation Rentals that are NOT their owner's Primary Residence:

- ~~Restrict all new or additional *shared housing units AND vacation rentals* that *ARE NOT* their owner's or tenant's primary residence.~~
- Restrict all new or additional *shared housing units* that **ARE NOT** their owner's or tenant's primary residence
- Restrict all new or additional *vacation rentals* that **ARE NOT** their owner's or tenant's primary residence.

Thomas Siska
Petitioner Name

Thomas Siska
Signature

1/19/18
Date





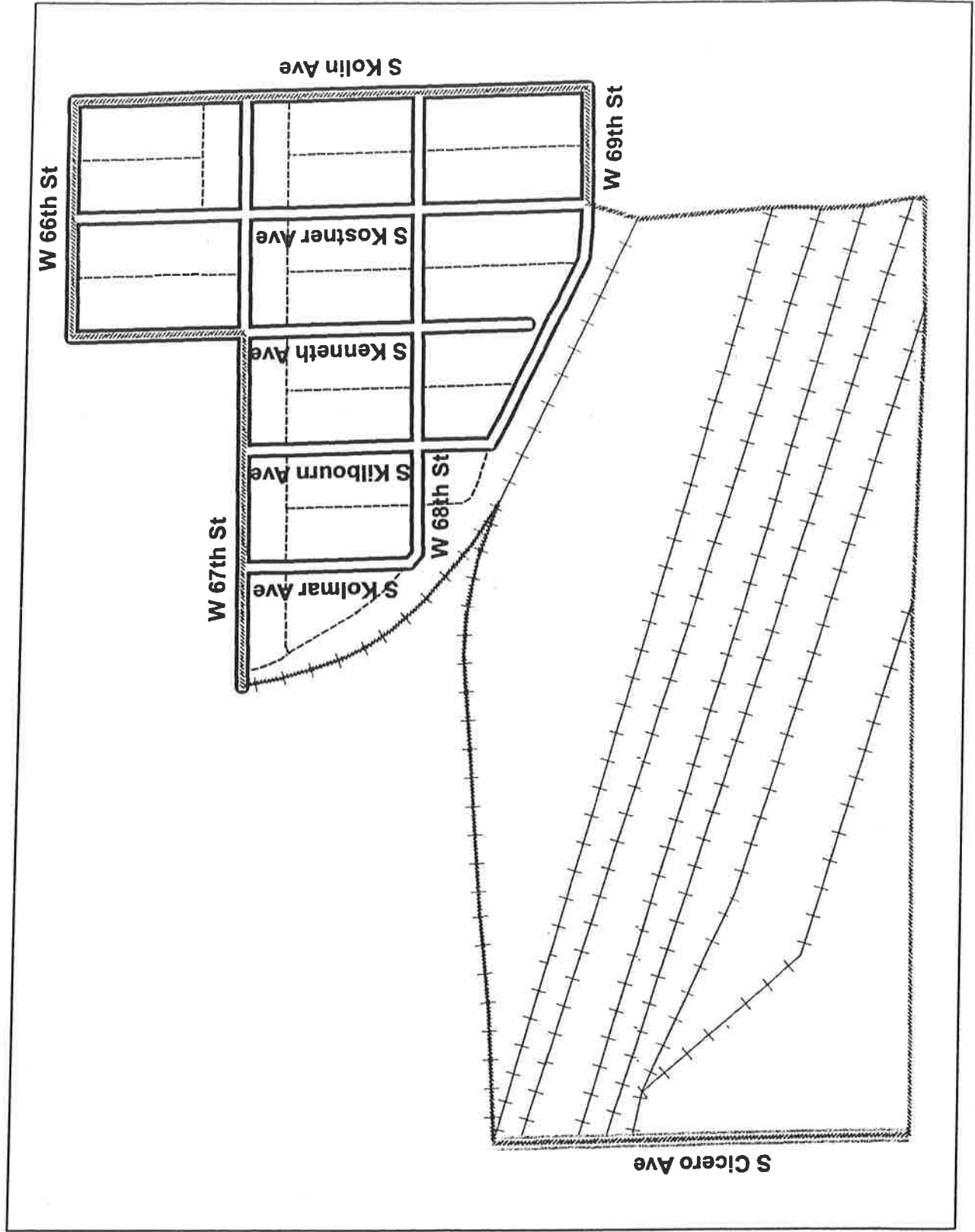

PCT 09 WARD 13

Beginning at the intersection of S. Cicero Av. and the Branch of the C R.R., thence east, northwest and north on the Branch of the C R.R. to W. 67th St., thence east on W. 67th St. to S. Kenneth Av., thence north on S. Kenneth Av. to W. 66th St., thence east on W. 66th St. to S. Kolin Av., thence south on S. Kolin Av. to W. 69th St., thence west on W. 69th St. to S. Kostner Av. (extended), thence south on S. Kostner Av. (extended) to W. 71st St. (extended), thence west on W. 71st St. (extended) to S. Cicero Av. and thence north on S. Cicero Av. to the place of beginning.

PCT 09 WARD 13

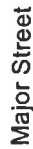
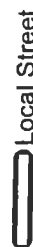
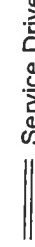

Legend

-  Precinct Boundary
-  Freeway
-  Major Street
-  Local Street
-  Service Drive
-  Ramp
-  Alley
-  Streams
-  Railroad

Board of Elections
 City of Chicago
 69 W Washington, Suite 600
 Chicago, IL 60602
 312-269-7900
www.chicagoelections.com

September 19, 2012

