



OFFICE OF THE CITY CLERK  
CITY OF CHICAGO  
ANNA VALENCIA

2018 JUN -6 AM 11:03  
OFFICE OF THE  
CITY CLERK

NOTICE OF INTENT FORM

1. Submit a complete and accurate description of the precinct you wish to restrict.

The description of the precinct boundaries of the 44 Precinct of the 13 Ward of the City of Chicago in the County of Cook and the State of Illinois, as such precinct existed as of the last General Election, is as follows:

please see attached.

2. Please select the scope of restriction sought for the 44 Precinct of the 13 Ward:

A: Restricting Shared Housing Units and Vacation Rentals

- Restrict all new or additional *shared housing units AND vacation rentals*.
- Restrict all new or additional *shared housing units*.
- Restrict all new or additional *vacation rentals*.

OR

B: Restricting Shared Housing Units and Vacation Rentals that are NOT their owner's Primary Residence:

- Restrict all new or additional *shared housing units AND vacation rentals* that ARE NOT their owner's or tenant's primary residence.
- Restrict all new or additional *shared housing units* that ARE NOT their owner's or tenant's primary residence
- Restrict all new or additional *vacation rentals* that ARE NOT their owner's or tenant's primary residence.

Jessica Molina  
Petitioner Name

Jessica Molina  
Signature

6/6/18  
Date







## PCT 44 WARD 13

Beginning at the intersection of S. Komensky Av. and W. 67<sup>th</sup> St./ W. Marquette Rd., thence east on W. 67<sup>th</sup> St./W. Marquette Rd. to S. Lawndale Av., thence south on S. Lawndale Av. to W. 68<sup>th</sup> St., thence west on W. 68<sup>th</sup> St. to S. Hamlin Av., thence south on S. Hamlin Av. to W. 68<sup>th</sup> Pl., thence west on W. 68<sup>th</sup> Pl. to S. Springfield Av., thence south on S. Springfield Av. to W. 69<sup>th</sup> St., thence west on W. 69<sup>th</sup> St. to S. Pulaski Rd., thence north on S. Pulaski Rd. to W. 68<sup>th</sup> St., thence west on W. 68<sup>th</sup> St. to S. Komensky Av., and thence north on S. Komensky Av. to the place of beginning.

# PCT 44 WARD 13



## Legend

-  Precinct Boundary
-  Freeway
-  Major Street
-  Local Street
-  Service Drive
-  Ramp
-  Alley
-  Streams
-  Railroad

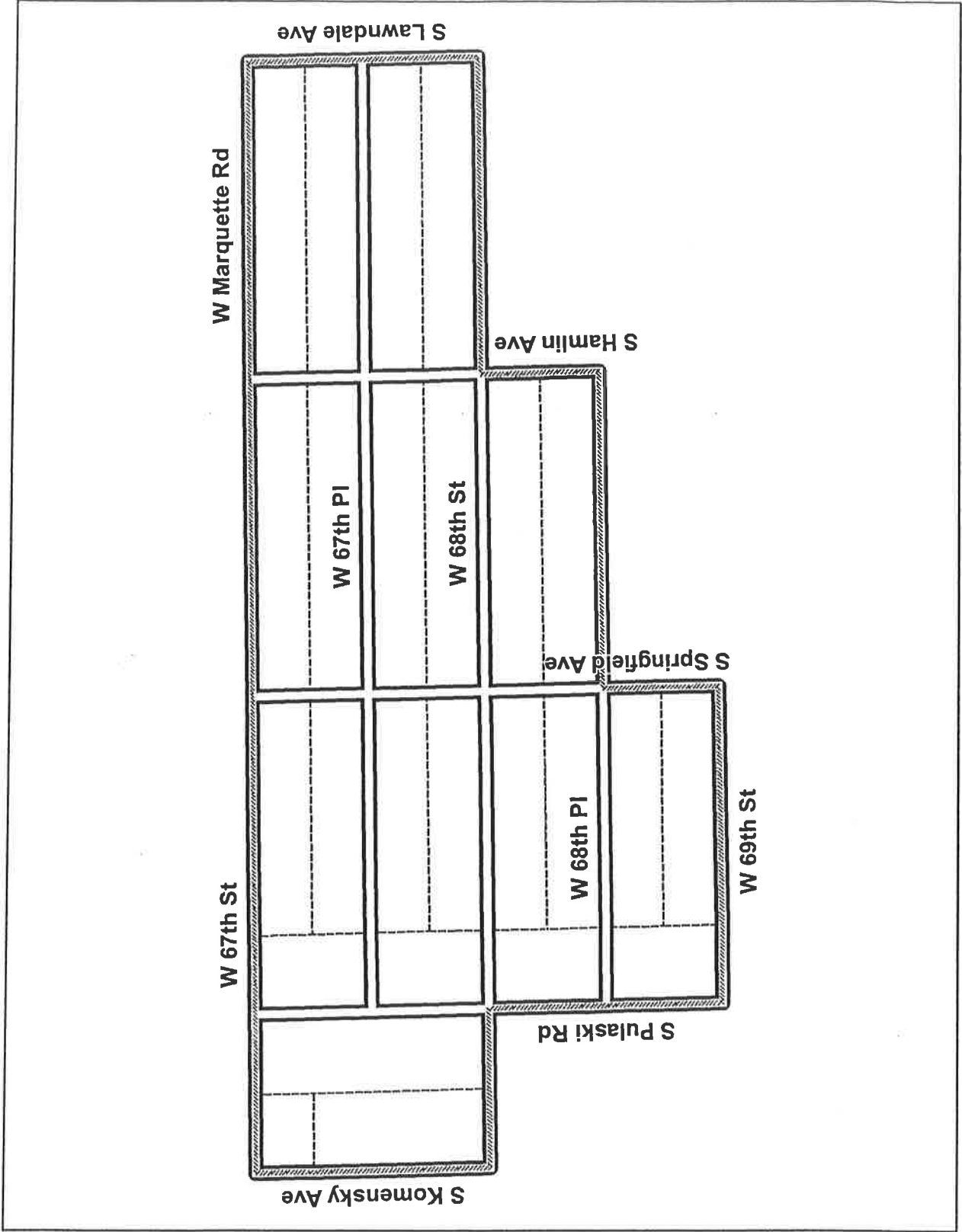

Board of Elections  
 City of Chicago  
 69 W Washington, Suite 600  
 Chicago, IL 60602  
 312-269-7900  
[www.chicagoelections.com](http://www.chicagoelections.com)

September 19, 2012

